

LEGEND	
AC	= ACRE
A.E.	= AERIAL EASEMENT
B.L.	= BUILDING LINE
CHB	= CHORD BEARING
CHD	= CHORD LENGTH
CIR	= CAPPED IRON ROD
D.E.	= DRAINAGE EASEMENT
E.E.	= ELECTRIC EASEMENT
ESMT.	= EASEMENT
H.C.C.F.	= HARRIS COUNTY CLERK'S FILE
H.C.D.	= HARRIS COUNTY DRAINAGE DISTRICT
H.C.D.R.	= HARRIS COUNTY DEED RECORDS
H.C.M.R.	= HARRIS COUNTY MAP RECORDS
H.L.&P.	= HOUSTON LIGHTING AND POWER
I.R.	= IRON ROD
I.P.	= IRON PIPE
L	= LENGTH
L.E.	= LANDSCAPE EASEMENT
LTD.	= LIMITED
No.	= NUMBER
NR	= NON-RADIAL
P.O.B.	= POINT OF BEGINNING
P.O.C.	= POINT OF COMMENCEMENT
P.U.E.	= PUBLIC UTILITY EASEMENT
PVT.	= PRIVATE
S.F.	= SQUARE FEET
SAN.S.E.	= SANITARY SEWER EASEMENT
STM.S.E.	= STORM SEWER EASEMENT
U.E.	= UTILITY EASEMENT
W.L.E.	= WATER LINE EASEMENT

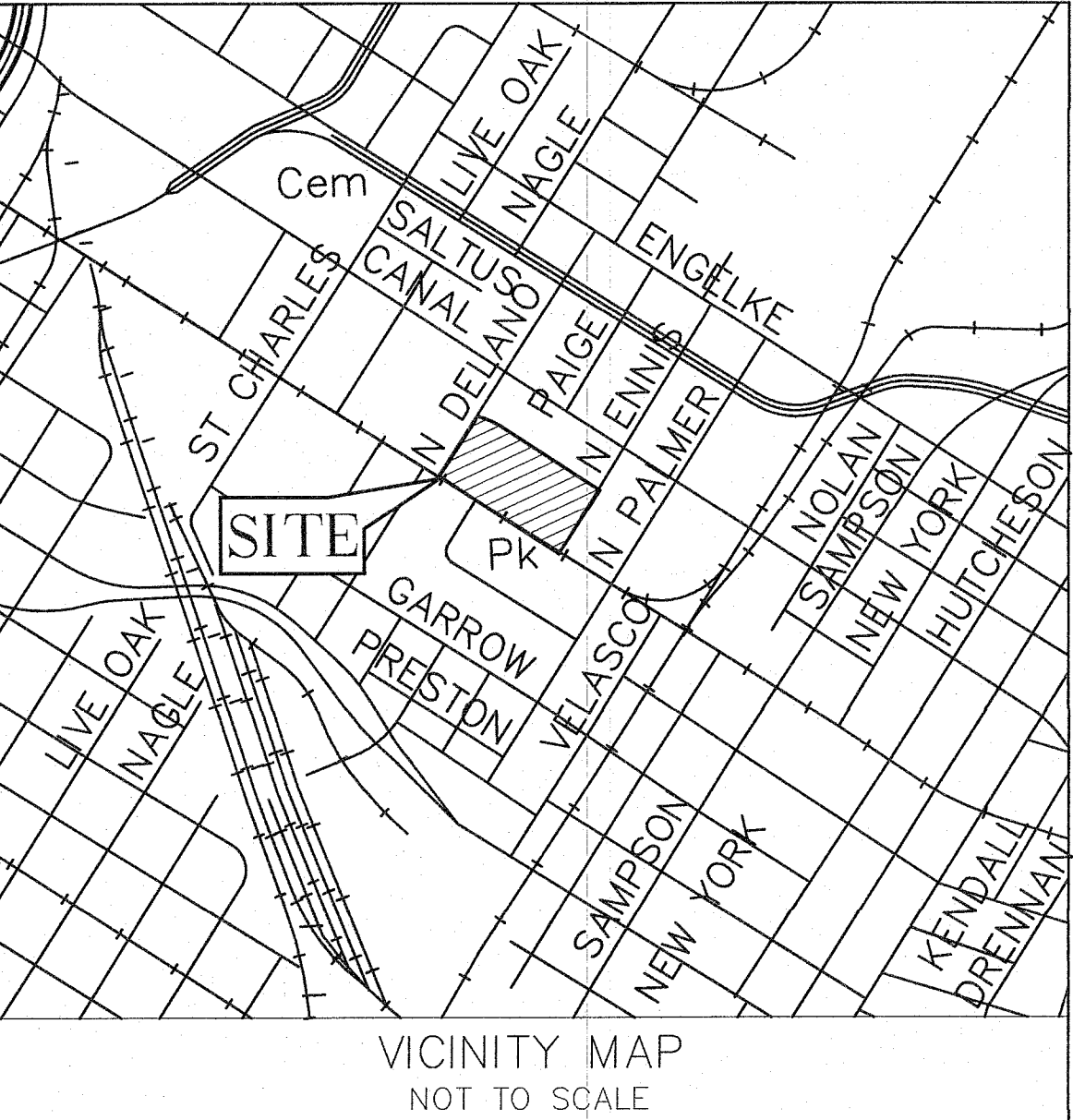

- NOTES
- THIS SURVEY WAS PREPARED WITH THE BENEFIT OF A COMMITMENT FOR TITLE INSURANCE ISSUED BY FIDELITY NATIONAL TITLE INSURANCE COMPANY, G.F. No.1033006810R, EFFECTIVE DATE OF JANUARY 7, 2018, ISSUED DATE OF FEBRUARY 1, 2018 WITH REGARD TO ANY RECORDED EASEMENTS, RIGHTS-OF-WAY OR SETBACKS AFFECTING THE SURVEYED PROPERTY. NO ADDITIONAL RESEARCH REGARDING THE EXISTENCE OF EASEMENTS, RESTRICTIONS, OR OTHER MATTERS OF RECORD HAS BEEN PERFORMED BY THE SURVEYOR.
  - ALL BEARINGS SHOWN HEREON ARE BASED ON THE TEXAS COORDINATE SYSTEM OF 1983, (NAD83) SOUTH CENTRAL ZONE, PER GPS OBSERVATIONS.
  - ACCORDING TO THE FEDERAL EMERGENCY MANAGEMENT AGENCY (FEMA) FLOOD INSURANCE RATE MAP No. 48201C0890N, REVISED DATE OF JANUARY 06, 2017, THE SURVEYED PROPERTY LIES WITHIN ZONE "X" (UNSHADED), AREAS DETERMINED TO BE OUTSIDE THE 0.2% ANNUAL CHANCE FLOODPLAIN.
  - A METES AND BOUNDS DESCRIPTION OF THE SURVEYED PROPERTY WAS PREPARED IN CONJUNCTION WITH AND ACCOMPANIES THIS SURVEY.
  - PROJECT BENCHMARK: RM No. 210030 BEING A HARRIS COUNTY FLOOD CONTROL BRASS DISK STAMPED "B811 1964" LOCATED AT JENSON DRIVE AND BUFFALO BAYOU LOCATED DOWNSTREAM, ON EAST SIDEWALK OF BRIDGE AT STREAM CENTERLINE. ELEVATION = 42.45 FEET, NAVD 88, 2001 ADJUSTMENT.
  - TEMPORARY BENCHMARK "A" BEING A BOX CUT ON INLET ON THE NORTHEAST CORNER OF DELAND STREET AND COMMERCE STREET, BEING APPROXIMATELY 48 FEET FROM THE CENTERLINE OF SAID INTERSECTION AND 32 FEET SOUTHWEST FROM A POWER POLE. ELEVATION = 40.14 FEET, NAVD 88, 2001 ADJUSTMENT.
  - TEMPORARY BENCHMARK "B" BEING AN X-CUT ON THE BACK OF CURB ON THE NORTH SIDE OF COMMERCE STREET, BEING APPROXIMATELY 23 FEET SOUTHWEST OF THE SOUTHEAST CORNER OF THE SUBJECT TRACT, AND 5 FEET WEST OF A POWER POLE. ELEVATION = 41.28 FEET, NAVD 88, 2001 ADJUSTMENT.
  - ALL ELEVATIONS SHOWN ON THIS SURVEY ARE BASED ON THE NAVD 88, 2001 ADJUSTMENT.

ELEVATIONS SHOWN HEREON ARE TRUE AND CORRECT AND BASED UPON AN ON THE GROUND SURVEY PERFORMED UNDER MY SUPERVISION ON THE 23RD DAY OF APRIL, 2018.

*Carolyn J. Quinn*  
CAROLYN J. QUINN, RPLS  
TEXAS REGISTRATION No. 60333  
JARDINE@MILLERSURVEY.COM

STATE OF TEXAS  
REGISTERED  
CAROLYN J. QUINN  
60333  
PROFESSIONAL LAND SURVEYOR

REVISED:

TOPOGRAPHIC SURVEY PLAT  
3.074 ACRES  
(133,916 SQ. FT.)  
LOCATED IN THE  
S.M. WILLIAMS SURVEY, A-87  
HARRIS COUNTY, TEXAS

MILLER  
SURVEY GROUP  
www.millersurvey.com  
1760 WEST SAM HOUSTON PARKWAY NORTH \* HOUSTON, TEXAS 77043  
PHONE 713-413-1900 \* FAX 713-413-1944  
TEXAS FIRM REGISTRATION NO. 10047100

JOB NO.: 3636-BV-05032018  
DWG. NO.: 3636-BV-05032018.DWG

SCALE: 1"= 50'  
DRAWN BY: JRW

DATE: 5/25/18  
CHECKED BY: CJO

FIELD BOOK: 18021/EA  
M&B No.: 181159

- SYMBOLS
- = FOUND 5/8-INCH IRON ROD (UNLESS OTHERWISE NOTED)
  - = SET 5/8-INCH IRON ROD (UNLESS OTHERWISE NOTED)
  - = A.C. PAD
  - = BLOW OFF VALVE
  - = BOLLARD
  - ⊗ = BUSH
  - ⊗ = CABLE BOX
  - ⊗ = CABLE MARKER
  - ⊗ = CLEAN-OUT
  - ⊗ = CURB INLET
  - ⊗ = E-INLET
  - ⊗ = ELECTRIC BOX
  - ⊗ = ELECTRIC MANHOLE
  - ⊗ = FIRE DEPARTMENT CONNECTION
  - ⊗ = FLAG POLE
  - ⊗ = FLUSH VALVE
  - ⊗ = GAS METER
  - ⊗ = GAS VALVE
  - ⊗ = GRATE INLET
  - ⊗ = GREASE TRAP
  - ⊗ = GUY ANCHOR
  - ⊗ = HANDICAPPED PARKING SPACE
  - ⊗ = IRRIGATION CONTROL VALVE
  - ⊗ = JUNCTION BOX
  - ⊗ = LIGHT STANDARD
  - ⊗ = WATER MANHOLE
  - ⊗ = PIPELINE MARKER
  - ⊗ = POWER POLE
  - ⊗ = POWER POLE W/LIGHT
  - ⊗ = SAMPLE WELL
  - ⊗ = SANITARY MANHOLE
  - ⊗ = SERVICE POLE
  - ⊗ = SIGN
  - ⊗ = SPRINKLER HEAD
  - ⊗ = STORM MANHOLE
  - ⊗ = TELEPHONE MANHOLE
  - ⊗ = TELEPHONE PEDESTAL
  - ⊗ = TRAFFIC SIGNAL CONTROL BOX
  - ⊗ = TRAFFIC SIGNAL POLE
  - ⊗ = WATER METER
  - ⊗ = WATER VALVE

LINE TYPES	
—x—x—x—	= BARBED-WIRE FENCE
—/—/—/—	= WOOD FENCE
—o—o—o—	= CHAIN-LINK FENCE
—□—□—□—	= WROUGHT IRON FENCE
—OH—OH—OH—	= OVERHEAD ELECTRIC LINE
—UE—UE—UE—	= UNDERGROUND ELECTRIC LINE
—GAS—GAS—GAS—	= UNDERGROUND GAS LINE
—FO—FO—FO—	= UNDERGROUND FIBER OPTIC LINE
—TL—TL—TL—	= UNDERGROUND TELEPHONE LINE
—STM—STM—STM—	= UNDERGROUND STORM LINE
—SCL—SCL—SCL—	= STORM LINE CULVERT
—SH—SH—SH—	= UNDERGROUND SANITARY LINE
—WL—WL—WL—	= UNDERGROUND WATER LINE
—C&G—C&G—C&G—	= CURB AND GUTTER LINE
—EAS—EAS—EAS—	= EDGE OF ASPHALT
—EGV—EGV—EGV—	= EDGE OF GRAVEL
—HBL—HBL—HBL—	= HIGH BANK LINE
—GBL—GBL—GBL—	= GRADE BREAK LINE
—TSL—TSL—TSL—	= TOE SLOPE LINE

