

File No. 28879

SKETCH SHOWING THE DAIRY SUBDIVISIONS TOWN as surveyed by W.D. Twitchell.

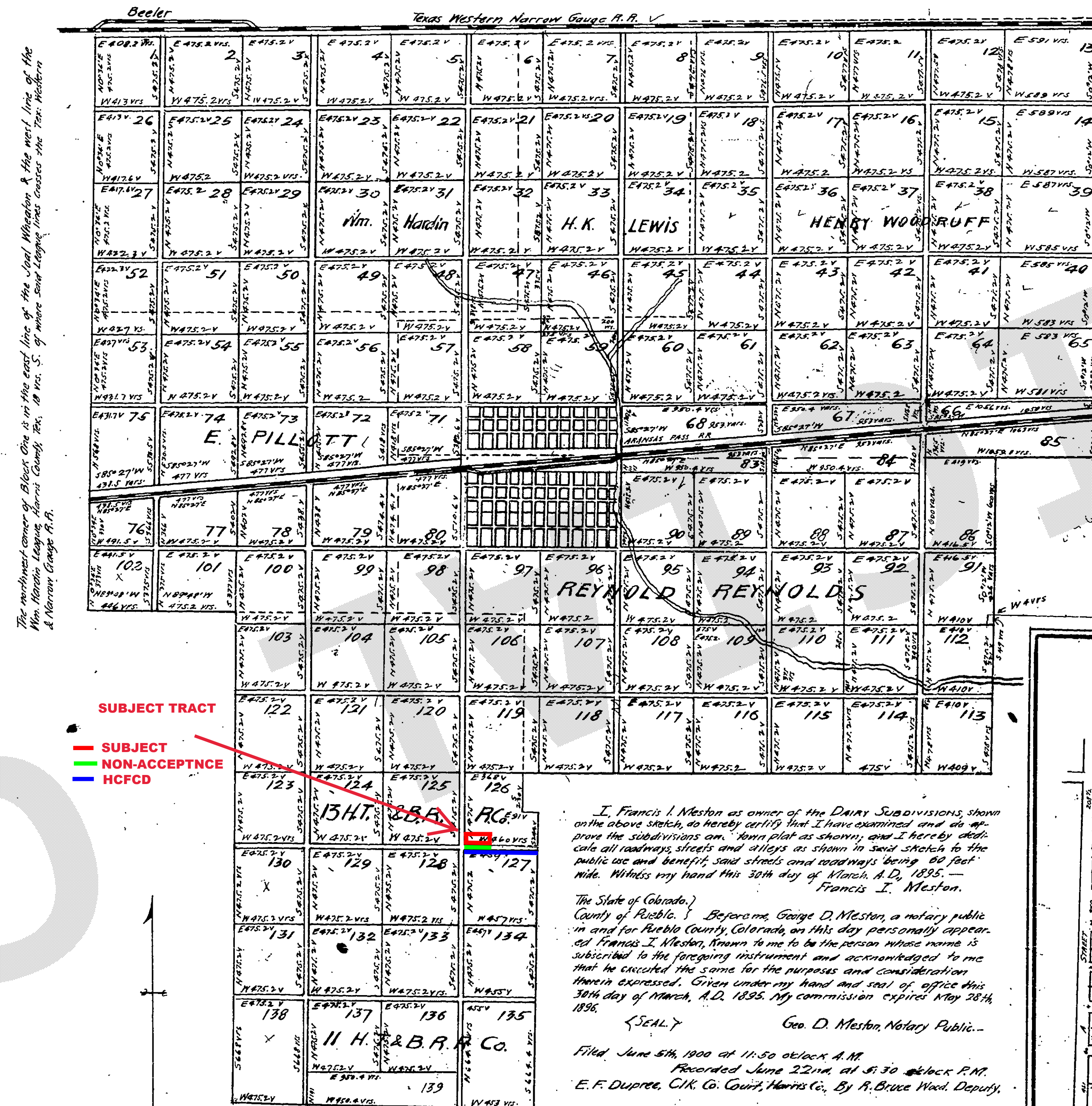

-Road Abandoned-
By order Commissioners Court
Between Blocks 64-65 & 66
per Commissioners Court Minutes
Vol. 11 - Page 54
Co. Clk. Rds. Vol. 1214, Pg. 310 Deed Records.
Jan. 22, 1942
W.D. MILLER
County Clerk, Harris County, Texas.
By H.R. Wiseman, Deputy.

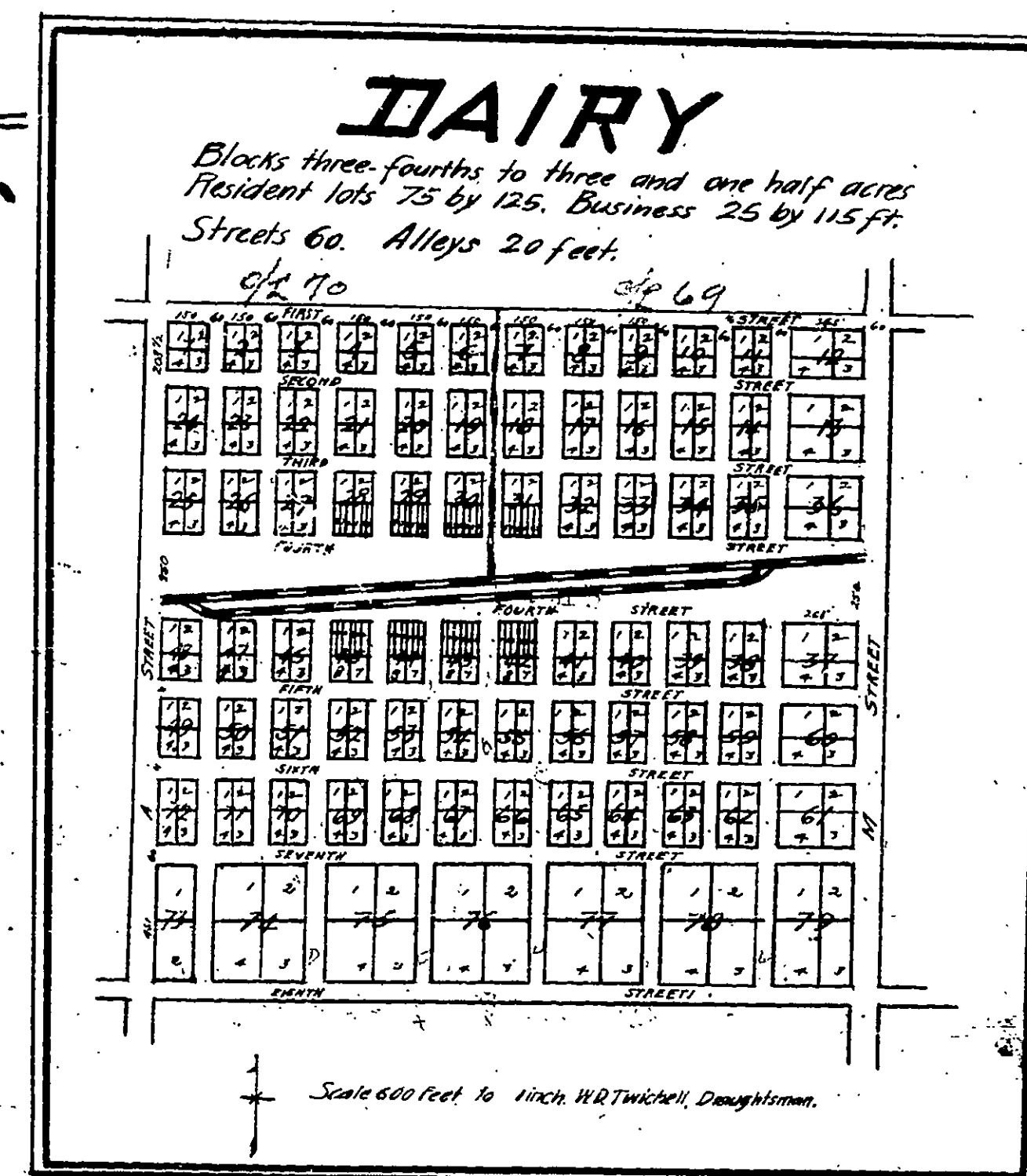

I, Francis I. Meston as owner of the DAIRY SUBDIVISIONS shown on the above sketch, do hereby certify that I have examined and do approve the subdivisions on "Town Plat as shown" and I hereby declare all easements, streets and alleys as shown to said sketch to the public use and benefit said streets and roadways being 60 feet wide. Witness my hand this 30th day of March, A.D. 1895.
Francis I. Meston.
The State of Colorado.)
County of Pueblo.) Before me, George D. Meston, a notary public in and for Pueblo County, Colorado, on this day personally appeared Francis I. Meston, known to me to be the person whose name is subscribed to the foregoing instrument and acknowledged to me that he executed the same for the purposes and consideration therein expressed. Given under my hand and seal of office this 30th day of March, A.D. 1895. My commission expires May 28th, 1896.
(Seal) Geo. D. Meston, Notary Public.
Filed June 5th, 1900 at 11:50 o'clock A.M.
Recorded June 22nd, at 5:30 o'clock P.M.
E.F. Dupree, C.L.K. Co. Clerk, Harris Co., By R. Bruce Wood, Deputy.